

[333_{v1}] Gerflor Smart Fix 16 dB

CONDITIONS

SUBSTRATES

ACCESSORIES

INSTALLATION

LAYING CONDITIONS

AUTHORIZED FLOOR COVERINGS		Virtuo 30 and 55 (only in premises classified max CEN 22), Creation 30 Design and Creation 55 Trend (see installation guidelines of the floor covering).
SUBSTRATE EVENNESS	Flatness requirement: < 5 mm / 2 metre ruler and < 1 mm / 20 cm ruler	Flat, clean, sound, dry and solid substrate.
STORAGE	At least 24 hours prior to installation	Store the underlayer in the room where it is going to be laid.
LAYING TEMPERATURE	15-26°C	Ideally 20°C.
PERIMETER EXPANSION GAP	5 mm	Around the edges of the room, fixed objects and door frames. The gap must be covered by a finishing profile.
DIVISIONS	Every 10 linear metres or surface area > 150 m	Each closed room or premises must be considered separately. Divide by applying Gerflor Fix&Free 100 double-sided adhesive tape to fix the underlayer to subfloor.
DIRECT SUNLIGHT (SUNNY AREAS, BAY WINDOWS, SKYLIGHTS, SKYDOMES, ETC.)	Floor temperature < 60°C	Loose laying is allowed as long as the ambient temperature is regulated. In order to prevent the floor temperature from reaching excessive values up to 60°C or above, direct sunlight on the floor should be obscured by curtains, blinds or other suitable protection. Otherwise, maintain the underlayer and the tiles/planks in place with a suitable adhesive (please contact the adhesive manufacturer).
VERANDA/CONSERVATORY	Prohibited	Prohibited, irrespective of the substrate.
FIRST USE	Pedestrian traffic - 48h Installation of the furniture - 72h	In case of underfloor heating, wait 7 days before turning the heating back on.

USAGE CONDITIONS

USAGE TEMPERATURE	Acceptable temperature range after installation : 20°C	e.g. +10°C to 30°C
STATIC LOADS	< 30 kg/cm ² and < 200 kg/support	Do not use rubber end caps. Use flat (not tapered) end caps without any pattern that are suitable for PVC. Use end caps on furniture legs.
CASTOR CHAIRS	PVC-compatible castors according to EN 12529	Recommendation: protective mat beneath castor chairs.

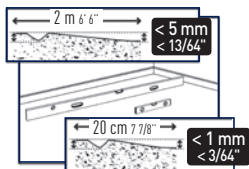

SUBSTRATE EVENNESS

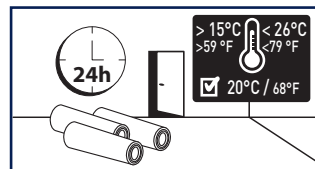

STORAGE

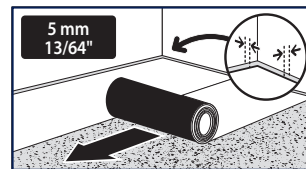

PERIMETER EXPANSION GAP

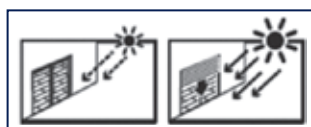
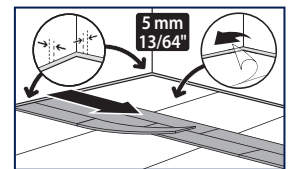

DIRECT SUNLIGHT



STATIC LOADS

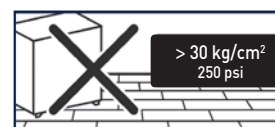

IMPORTANT: The information in this document is valid from 15/01/2025 and is subject to change without prior notice. As we carry out continuous technical improvements, our customers should check with us that this document is still in force before starting any work.

Gerflor

[333_{v1}] Gerflor Smart Fix 16 dB

CONDITIONS	SUBSTRATES	ACCESSORIES	INSTALLATION
------------	-------------------	-------------	--------------

SUBSTRATE		CONDITIONS For installing this floor covering
Concrete floor, painted concrete, levelling compound, cement based screed, anhydrite (calcium sulphate)-based screed	✓	Moisture content compliant with the relevant standards and regulation in the country of use, and always < 4% (80%RH) for cement based substrate and < 0.5% for an anhydrite-based substrate. If necessary, prepare the support and apply a smoothing compound to eliminate any irregularities
Ceramic tiles	✓	The floor surface must not have any uneven areas and the joints must not be recessed. If necessary, apply a levelling compound to eliminate any surface irregularities.
Glued compact PVC / rubber / linoleum floor coverings	✓	After examination and repair depending on the condition of the floor covering. If more than 10% is in bad condition, complete removal is necessary followed by new substrate preparation
Foam backed PVC floor coverings	✗	Prohibited
Textile floor covering (carpet) / textile-backing PVC floorings	✗	Prohibited
Vinyl asbestos tiles	✓	Refer to Gerflor's Technical Guide for Overlaying Asbestos Floors
Glued or floating parquet / laminated floor / floating wood based panels	✗	Prohibited
OSB or wood-based panel flooring on joists or battens	!	Apply a fiber-reinforced levelling compound after treatment of any unevenness and joints between panels
Parquet nailed on battens ventilated underneath	!	Treat any possible defects on the substrate (unevenness, open joints between planks ...) then apply a fiber-reinforced levelling compound (directly or on lining boards).
Water reversible underfloor heating	✓	Allowed
Underfloor heating with circulating water, max temperature 28°C	✓	Allowed
Radiant electric underfloor heating	✗	Prohibited

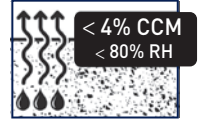

The preparation of the substrate must comply with the current relevant standards in the country of use.
For any information on product properties and usages, please refer to its technical datasheet: www.gerflor.com.

[333_{v1}] Gerflor Smart Fix 16 dB

CONDITIONS

SUBSTRATES

ACCESSORIES

INSTALLATION

TOOLS

Cutter - Tape measure - Metal ruler

ADHESIVES FOR DIRECT SUNLIGHT AREAS

Fix&Free 740

DIVISIONS

FIX&FREE 100 and ROMUS accessories

FINISHES

Skirting Design - Ref. : 6086 / Skirting Design - MDF - Ref. : 5947 – See Installation Guidelines [504A] and [504B]

Ramp / Threshold / Expansion Gaps : design coverstrip Ref. 0647

[333_{v1}] Gerflor Smart Fix 16 dB

CONDITIONS

SUBSTRATES

ACCESSORIES

INSTALLATION



The floor covering should be examined prior to installation for any visible defects. The flooring must belong to the same production batch. If there are any visible defects, please notify GERFLOR and do not begin installation without its prior approval.

LAYING FLAT

- Unroll the underlayer with the adhesive-coated side facing upwards, perpendicular to the direction of installation of planks/tiles.

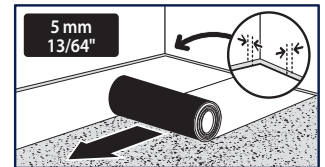

- Position the underlayer strips edge to edge.

- If necessary, divide the laying with Gerflor Fix&Free 100 double-sided adhesive tape (see laying conditions)

INSTALLATION AND CUTTING OUT

- Trim the underlayer along the walls or existing skirtings, leaving a 5 mm perimeter expansion gap.

- Tiles/planks must be laid perpendicular to the direction in which the underlay is laid. Avoid laying underlay joints and plank/tile joints side-by-side.

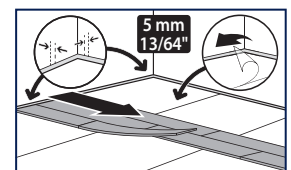

- Remove the protective paper progressively as the tiles/planks are being laid. Install tiles/planks in compliance with the associated installation guidelines. Stretch and flatten the underlay by hand during installation.

- In case of division, the division of the planks/tiles must match that of the underlayer.